

QUICK START GUIDE

Important: Please read before you operate your Tivax HiRez⁷ TV

Basic Instructions (for detailed instructions please refer to our 40 page user manual)

Please:

- Install the Li-Ion batteries.
 - Note the Li-Ion batteries are different sizes. Insert the batteries in the appropriate slots on the back of the TV.
 - Remove the cover for the compartment by lightly pushing and sliding it in the direction of the arrow.

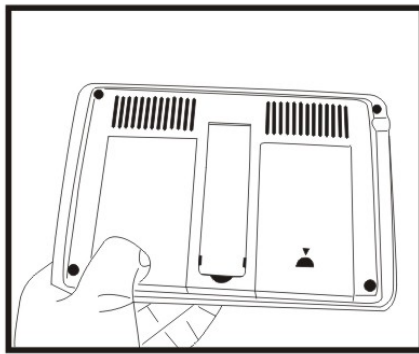

- Insert the batteries, smaller in the right slot and larger in the left.

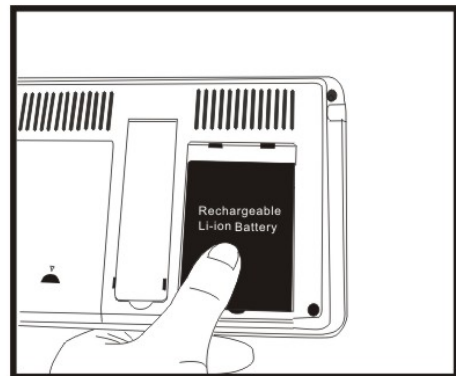
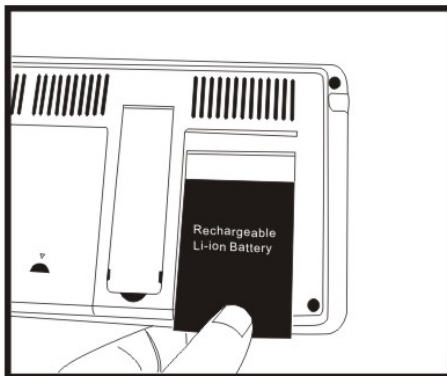

- Replace the cover by sliding back into place.

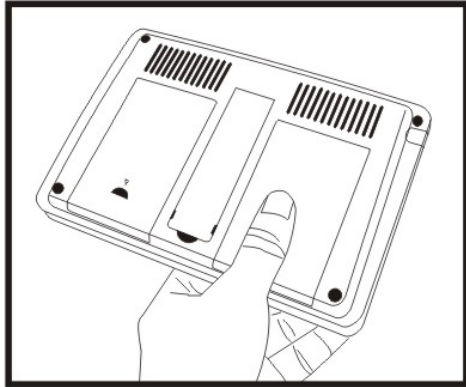

Initial Charge: The Li-Ion batteries are approximately 60% charged prior to shipping. Before first use batteries should be charged 8 to 12 hours. During this initial charge, please continue charging even after the LED charge indicator light turns to green.

Re-charging: After initial use, it will only take 3 hours for depleted batteries to be charged fully. A full charge will then be indicated when the LED on the bottom right turns to green. A normal lifetime for the Li-Ion batteries is approximately 500 re-charges.

- Connect your TV to a power source either battery or power supply
- Connect your TV firmly to either an antenna for free over-the-air signals or to a cable outlet.
- Turn switch on the side of the unit to “ON” position. The Tivax HI-Rez⁷ does not have a standby feature. The On/OFF switch is used in order to conserve battery life.
- Scan the TV for channels available in your area before initial use or after you have changed the location of the TV.

Scanning:

- Press down the “Menu” button on your Hi-Rez⁷ remote control. The Main – Main Menu will appear on the TV screen.

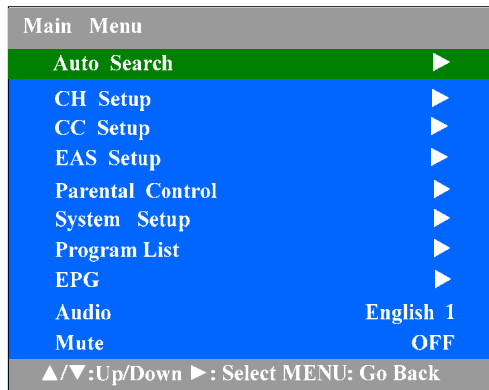

- The item highlighted on the top of the Main Menu is “Auto Search”.
- Press the right arrow (Vol+) on your remote.
- The Auto Search window now appears on your screen. The highlighted item is now “Source Type”.
- Use the right arrow (Vol+) button to select either Antenna or Cable depending on the connection source for your signal.

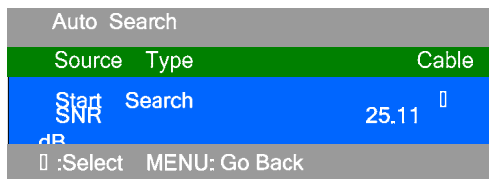

- Once Channel or Cable is selected, press the down arrow (CH-) on the remote to highlight the next selection: “Start Search”.
- Press the right arrow (Vol+) to start the search for channels available in your area.
- Wait for TV to conclude search for digital stations.

Additional Notes

- Please be aware the number of channels received depends on your proximity to the broadcast tower. You may require a more powerful antenna to secure more channels. An adapter will be required to connect to this antenna. Such an adapter is not included in this package.

- Although your TV is highly portable, digital reception may be poor when moving, as when in a vehicle. For best digital reception the TV must be stationary. This characteristic is true for any digital TV.
- The Tivax Hi-Rez⁷ has no provision to accept any batteries other than the two provided Li-Ion batteries.
- The Tivax Docking Station (optional) does accommodate AA batteries. This option will soon be available to Hi Rez⁷ users.
- Your TV will also work with a 12V power supply through the included car battery adapter. Such a connection will also re-charge the internal LI-Ion batteries.
- The included AC adapter both powers the TV and charges the batteries. There is no need to remove the batteries when using the AC adapter.

Replacing the battery in your remote control unit

- The remote unit comes with a CR2025 button battery (already installed).
- Replace the CR2025 battery by turning the remote over so the bottom is facing up. There is a small “catch” on the right-hand side of the battery compartment. Push it to the left with a finger-nail, simultaneously pulling the battery tray toward you. (refer to accompanying sketch)

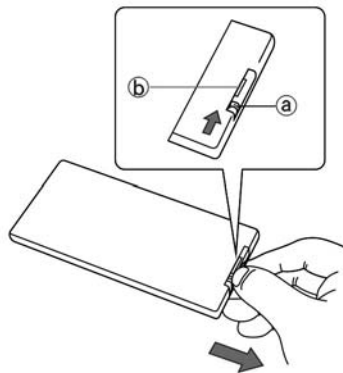

- Place a new battery in tray, and re-insert the tray making sure the (+) mark is facing upwards.

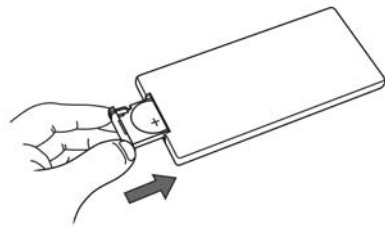
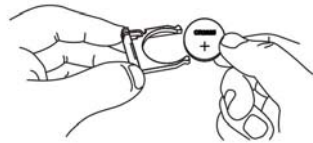

Questions? Please contact us at the information below from 9am to 5pm PST.

General Information:

info@tivax.com

1-888-33-Tivax (1-888-338-4829)

Customer Support:

support@tivax.com

Thank you for choosing Tivax!



www.tivax.com